



techhose

QUALITY CONNECTIONS

Hydraulics

Pneumatics
& Vacuum

Industrial

Compressed Air
& Ring Main

Process &
Instrumentation

Push-in Fittings & Tubing

Air Brake Push-in Fittings

AIR BRAKE FITTINGS

Male Stud Couplings Mix Box

Contains:

2 x M12 x 8, 2 x M16 x 12, 2 x M16 x 8,
2 x M22 x 12, 2 x M16 x 10, 1 x M22 x 15,
2 x M22 x 10, 1 x M22 x 18



14 Piece

1360
008ABK

Male Stud Elbow Mix Box

Contains:

2 x M12 x 8, 1 x M22 x 10, 2 x M16 x 8,
1 x M16 x 12, 2 x M22 x 8, 1 x M22 x 12,
2 x M12 x 10, 1 x M22 x 15, 2 x M16 x 10,
1 x M22 x 18

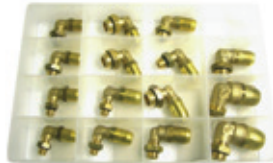

15 Piece

1360
081ABK

Straight Connectors Mix Box

Contains:

2 x 6 mm, 2 x 12 mm, 2 x 8 mm,
2 x 15 mm, 2 x 10 mm, 2 x 16 mm,
1 x 18 mm



15 Piece

1360
085ABK

Workshop & Mobile Full Repair/Service Kit

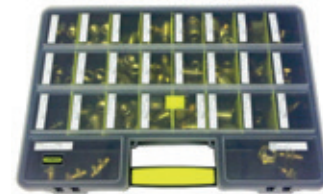

120 Piece

1360
086ABK

Male Studs



Metric

1360	OD mm	Thread
800212ABF	6	M12
800216ABF	6	M16
800312ABF	8	M12
800316ABF	8	M16
800322ABF	8	M22
800412ABF	10	M12
800416ABF	10	M16
800422ABF	10	M22
800516ABF	12	M16
800522ABF	12	M22
800622ABF	15	M22
800722ABF	16	M22
800822ABF	18	M22
800826ABF	18	M26

Male Stud Elbows



Metric

1360	OD mm	Thread
810212ABF	6	M12
810216ABF	6	M16
810312ABF	8	M12
810316ABF	8	M16
810322ABF	8	M22
810412ABF	10	M12
810416ABF	10	M16
810422ABF	10	M22
810516ABF	12	M16
810522ABF	12	M22
810622ABF	15	M22
810722ABF	16	M22
810822ABF	18	M22

Bulkheads



Metric

1360	Thread
703222ABF	M22 x M16 x F10 mm
703322ABF	M22 x M18 x F12 mm
703522ABF	M22 x M22 x F16 mm

Hex Straight



Metric

1360	Thread
750300ABF	M12
750500ABF	M16
750700ABF	M22

AIR BRAKE FITTINGS

Straight Joiners



Tube

1360	OD mm
850200ABF	6
850300ABF	8
850400ABF	10
850500ABF	12
850600ABF	15
850700ABF	16
850800ABF	18

Elbow Joiners



Tube

1360	OD mm
860200ABF	6
860300ABF	8
860900ABF	9
860400ABF	10
860110ABF	11
860500ABF	12
860600ABF	15
860700ABF	16
860800ABF	18

Tee Joiners



Tube

1360	OD mm
870200ABF	6
870300ABF	8
870400ABF	10
870500ABF	12
870600ABF	15

Elbows



Female Thread, Metric

1360	Thread
760300ABF	M12
760500ABF	M16
760700ABF	M22



Male Thread x Female Thread, Metric

1360	Male Thread	Female Thread
710312ABF	M12	M12
710316ABF	M16	M12
710322ABF	M22	M12
710516ABF	M16	M16
710522ABF	M22	M16
710722ABF	M22	M22

F Elbow, Male Thread x Female Thread, Metric



1360	Male Thread	Female Thread
743516ABF	M16	M16

45° Elbow, Male Thread x Female Thread, Metric



1360	Male Thread	Female Thread
740516ABF	M16	M16
740722ABF	M22	M22

Tees



Female Thread, Metric

1360	Thread
770300ABF	M12
770500ABF	M16
770700ABF	M22



Male Thread x Female Thread, Metric

1360	Male Thread	Female Thread
730312ABF	M12	M12
730316ABF	M16	M12
730322ABF	M22	M12
730516ABF	M16	M16
730522ABF	M22	M16
730722ABF	M22	M22

Stud Run Tee



Male Thread x Female Thread, Metric

1360	Male Thread	Female Thread
720312ABF	M12	M12
720316ABF	M16	M12
720322ABF	M22	M12
720516ABF	M16	M16
720522ABF	M22	M16
720722ABF	M22	M22

AIR BRAKE FITTINGS



Test Points



Male Thread, Metric

1360	Thread
TPM12T	M12
TPM16T	M16
TPM22T	M22

Drain Taps



Male Thread, Metric

1360	Thread
TT3T	M22

Blanking Plugs



Male Thread, Metric

1360	Thread
BP12B	M12
BP16B	M16
BP22B	M22

AIR BRAKE SWIVEL FITTINGS



Male Studs



Male Thread, Metric

1360	Thread
660502ABF	1/8"
660504ABF	1/4"
660510ABF	M10
660512ABF	M12
660514ABF	M14
660516ABF	M16
660522ABF	M22
660526ABF	M26

Elbow



Female Thread, Metric

1360	Thread
615500ABF	M16

45° Elbow



Female Thread, Metric

1360	Thread
645500ABF	M16

Elbow Joiners



Tube

1360	Tube OD mm
815200ABF	6
815300ABF	8
815400ABF	10
815500ABF	12

Tee



Female Thread, Metric

1360	Thread
635500ABF	2 x M16

Side Tee



Female Thread, Metric

1360	Thread
625500ABF	2 x M16

Cross



Female Thread, Metric

1360	Tube OD mm
646500ABF	3 x M16

Series 9000 C-Truck

Brass fittings



Automation



The safe and practical solution for pneumatic braking systems

Series 9000 C-Truck fittings have been designed to connect tubes in the pneumatic braking systems on industrial and commercial vehicles ensuring reliability and ease of assembling. The use of a proper disconnection tool enables disconnection of the tube without having to remove the fitting. All fittings have a protective cap that keeps humidity and dirt away from the collet. A reinforced insert enables the dimensions of the tube to remain constant, thus ensuring a tight and safe connection even with high changes in temperature. Indeed, Series 9000 C-Truck fittings can be used at extreme temperatures (from -50°C to +100°C). They are assembled according to a precise angle and supplied with locking nut and a self sealing O-ring. The O-ring on the thread is set in a special groove of the threaded part, ensuring there is no damage during assembly. The brass body guarantees a high resistance to corrosion, whilst the O-ring and protective cap are made from oil resistant rubber. All fittings are supplied pre-assembled and ready to use.



General Data

Materials: see table of materials

Thread: Metric NPT

Media: Compressed air

Max working pressure: 16 bar

Note: pressure depends on tube characteristics

Temperature: -50°C ÷ +100°C

Tube: Material Polyamide

Tube diameters (D/d): 4/2, 6/4, 8/6, 10/7, 10/8, 12/9, 15/11, 15/12, 16/12, 16/13 and 18/14

 Certification

Camozzi
Air that moves the world

AIR BRAKE PUSH-IN FITTINGS C-TRUCK 9000 SERIES

Table of Materials

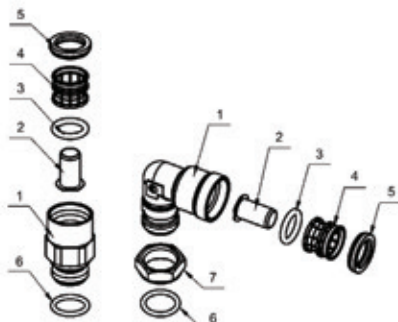

Parts	Materials
1 = Body	Brass
2 = Insert	Technopolymer (Brass only for Ø10/7, 15/11, 16/12, 16/13 and 18/14)
3 = S-rapid	O-Ring NBR
4 = Collet	Brass
5 = Protective seal	NBR
6 = O-Ring for thread	NBR
7 = Locking ring	Steel

Fittings Assembly in the System

To guarantee the tightening of the fitting in the system, make sure that the thread chamfer conforms to the standard ISO 965 or GOST 10549-80.

The fittings which have an O-Ring seal on the thread, but no locking nut, have to be screwed into the system with the torque forces as shown in the table below.

For the assembly of fittings with locking nut, it is necessary to do the following:

1. Loosen the locking nut
2. Screw the fitting into the system until the O-Ring comes into contact with the system surface
3. Position the fitting according to the suitable angle, moving the body up to 360°
4. Keep the body still
5. Screw the locking nut with torque forces as shown in the table

Thread	Torque force (Nm)
M10 x 1	11 - 15
M12 x 1.5	15 - 19
M14 x 1.5	19 - 23
M16 x 1.5	24 - 30
M18 x 1.5	27 - 33
M22 x 1.5	36 - 44

Straight Adaptors



Male, Metric

0322	Thread	OD mm
9512-6-M10	M10 x 1	6
9512-6-M12	M12 x 1.5	6
9512-6-M14	M14 x 1.5	6
9512-6-M16	M16 x 1.5	6
9512-8-M10	M10 x 1	8
9512-8-M12	M12 x 1.5	8
9512-8-M14	M14 x 1.5	8
9512-8-M16	M16 x 1.5	8
9512-8-M22	M22 x 1.5	8
9512-10-M12	M12 x 1.5	10
9512-10-M16	M16 x 1.5	10
9512-10-M18	M18 x 1.5	10
9512-10-M22	M22 x 1.5	10
9512-10/7-M12	M12 x 1.5	10/7
9512-10/7-M16	M16 x 1.5	10/7
9512-10/7-M22	M22 x 1.5	10/7
9512-12-M12	M12 x 1.5	12
9512-12-M14	M14 x 1.5	12
9512-12-M16	M16 x 1.5	12
9512-12-M22	M22 x 1.5	12
9512-15-M16	M16 x 1.5	15
9512-15-M22	M22 x 1.5	15
9512-15/11-M16	M16 x 1.5	15/11
9512-16-M22	M22 x 1.5	16
9512-16/12-M16	M16 x 1.5	16/12
9512-16/12-M22	M22 x 1.5	16/12
9512-18-M22	M22 x 1.5	18

Tech Sheet 20453



Male, NPT

0322	Thread	OD mm
9510-6-02	1/8"	6
9510-05-02	1/8"	8



Female, Metric

0322	Thread	OD mm
9463-6-M10	M10 x 1	6
9463-6-M16	M16 x 1.5	6
9463-8-M10	M10 x 1	8

Elbow Adaptors



Male, Metric

0322	Thread	OD mm
9502-6-M10	M10 x 1	6
9502-6-M12	M12 x 1.5	6
9502-6-M16	M16 x 1.5	6
9502-6-M22	M22 x 1.5	6
9502-8-M10	M10 x 1	8
9502-8-M12	M12 x 1.5	8
9502-8-M14	M14 x 1.5	8
9502-8-M16	M16 x 1.5	8
9502-8-M22	M22 x 1.5	8
9502-10-M12	M12 x 1.5	10
9502-10-M16	M16 x 1.5	10
9502-10-M22	M22 x 1.5	10
9502-10/7-M12	M12 x 1.5	10/7
9502-10/7-M16	M16 x 1.5	10/7
9502-10/7-M22	M22 x 1.5	10/7
9502-12-M12	M12 x 1.5	12
9502-12-M16	M16 x 1.5	12
9502-12-M22	M22 x 1.5	12
9502-15-M16	M16 x 1.5	15
9502-15-M22	M22 x 1.5	15
9502-16-M22	M22 x 1.5	16
9502-16/12-M16	M16 x 1.5	16/12
9502-16/12-M22	M22 x 1.5	16/12
9502-18-M22	M22 x 1.5	18

Tech Sheet 20453



Double Push-in, Male, Metric

0322	Thread	OD mm
9402-12-M16	M16 x 1.5	12
9402-12-M22	M22 x 1.5	12

Tech Sheet 20453



Male, NPT

0322	Thread	OD mm
9500-6-02	1/8"	6
9500-05-02	1/8"	8

Tech Sheet 20453

AIR BRAKE THREADED FITTINGS C-TRUCK 9000 SERIES

Tee Adaptors



Male Branch, Metric

0322	Thread	OD mm
9412-6-M10	M10 x 1	6
9412-6-M12	M12 x 1.5	6
9412-6-M16	M16 x 1.5	6
9412-8-M12	M12 x 1.5	8
9412-8-M16	M16 x 1.5	8
9412-8-M22	M22 x 1.5	8
9412-10-M12	M12 x 1.5	10
9412-10-M16	M16 x 1.5	10
9412-10-M22	M22 x 1.5	10
9412-10/7-M12	M12 x 1.5	10/7
9412-10/7-M16	M16 x 1.5	10/7
9412-10/7-M22	M22 x 1.5	10/7
9412-12-M12	M12 x 1.5	12
9412-12-M16	M16 x 1.5	12
9412-12-M22	M22 x 1.5	12
9412-15-M16	M16 x 1.5	15
9412-15-M22	M22 x 1.5	15
9412-15/11-M16	M16 x 1.5	15/11
9412-15/11-M22	M22 x 1.5	15/11

Tech Sheet 20453



Male Branch, NPT

0322	Thread	OD mm
9410-6-02	1/8"	6
9410-05-02	1/8"	8

Tech Sheet 20453



Male Run, Metric

0322	Thread	OD mm
9422-6-M10	M10 x 1	6
9422-6-M12	M12 x 1.5	6
9422-6-M16	M16 x 1.5	6
9422-8-M12	M12 x 1.5	8
9422-8-M16	M16 x 1.5	8
9422-8-M22	M22 x 1.5	8
9422-10-M16	M16 x 1.5	10
9422-10-M22	M22 x 1.5	10
9422-12-M12	M12 x 1.5	12
9422-12-M16	M16 x 1.5	12
9422-12-M22	M22 x 1.5	12
9422-15-M16	M16 x 1.5	15
9422-15-M22	M22 x 1.5	15

Tech Sheet 20453



Male Run, NPT

0322	Thread	OD mm
9420-6-02	1/8"	6
9420-05-02	1/8"	8

Tech Sheet 20453

Y Piece Adaptors



Male, Metric

0322	Thread	OD mm
9450-8-M16	M16 x 1.5	8
9450-12-M16	M16 x 1.5	12
9450-12-M22	M22 x 1.5	12

Tech Sheet 20453

Straight Couplings



Tube x Tube

0322	OD mm
9580-6	6
9580-8	8
9580-10	10
9580-12	12
9580-15/11	15/11
9580-16/12	16/12
9580-18/14	18/14

Tech Sheet 20453

Elbows



Tube x Tube

0322	OD mm
9550-6	6
9550-8	8
9550-10	10
9550-12	12

Tech Sheet 20453

Tees



Equal, Tube x Tube

0322	OD mm
9540-6	6
9540-8	8
9540-10	10
9540-12	12
9540-15/11	15/11

Tech Sheet 20453



Branch Unequal, Tube x Tube

0322	OD mm	OD mm
9540-8-8-6	8	6
9540-12-12-8	12	8

Tech Sheet 20453

Bulkhead Couplings



Male, Metric

0322	Thread	OD mm
9590-8-M18	M18 x 1.5	8
9590-8-M18-S01	M18 x 1.5	8
9590-12-M18	M18 x 1.5	12
9590-12-M18-S01	M18 x 1.5	12

Tech Sheet 20453

Bulkhead Couplings



Female, Metric

0322	Thread	OD mm
9592-8-8-M18	M18 x 1.5	8
9592-12-8-M18	M18 x 1.5	12

Tech Sheet 20453

AIR BRAKE THREADED FITTINGS C-TRUCK 9000 SERIES

Tees

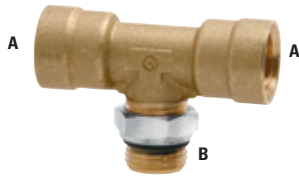

Male x Female Branch, Metric

0322	Thread A	Thread B
D2062-M16XM12	M16 x 1.5	M12 x 1.5
D2062-M16XM16	M16 x 1.5	M16 x 1.5
D2062-M16XM22	M22 x 1.5	M16 x 1.5
D2062-M22XM22	M22 x 1.5	M22 x 1.5

Tech Sheet 20453

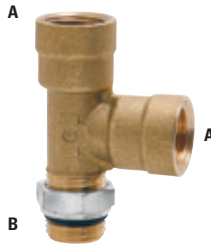

Male x Female Run, Metric

0322	Thread A	Thread B
D2072-M16XM12	M16 x 1.5	M12 x 1.5
D2072-M16XM16	M16 x 1.5	M16 x 1.5
D2072-M16XM22	M22 x 1.5	M16 x 1.5
D2072-M22XM22	M22 x 1.5	M22 x 1.5

Tech Sheet 20453



Equal Female, Metric

0322	Thread
D2003-M16	M16 x 1.5
D2003-M22	M22 x 1.5

Tech Sheet 20453

Equal Female, Metric (Mountable)

0322	Thread
D2003-M16-S01	M16 x 1.5

Tech Sheet 20453



Double Female, Metric

0322	Thread
D3043-M16-2D-S01	M16 x 1.5

Tech Sheet 20453

Bulkheads

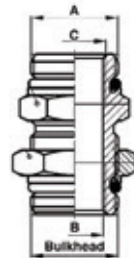

Female, Metric

0322	Thread A	Thread B	Thread C	Bulkhead
D2512-M22XM16	M16	M16	M10	M22
D2502-M22XM22	M22	M16	M16	M22

Tech Sheet 20453

Elbows



Male x Female, Metric

0322	Thread A	Thread B
D2022-M16XM16	M16 x 1.5	M16 x 1.5
D2022-M16XM22	M22 x 1.5	M16 x 1.5
D2022-M22XM22	M22 x 1.5	M22 x 1.5

Tech Sheet 20453

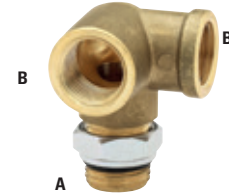

Male x Female, 2 Way Elbow, Metric

0322	Thread A	Thread B
D2077-M16-S01	M16 x 1.5	M16 x 1.5
D2077-M16M22S01	M16 x 1.5	M22 x 1.5

Tech Sheet 20453

Cross



Male x Female, Metric

0322	Thread
D2032-M16	M16 x 1.5

Tech Sheet 20453

For Air Brake Tubing
see page 910



AIR BRAKE ACCESSORIES C-TRUCK 9000 SERIES

Hosetail Adaptors



Male, Metric

0322	Thread	OD mm	Length A mm
D2602-10-M16-L30	M16 x 1.5	11	30
D2602-12-M16X1.5	M16 x 1.5	12.5	20
D2602-11.5M16L35	M16 x 1.5	12.5	35

Tech Sheet 20453

Release Tools



Metric

0322	To Suit mm
DRK 6	6
DRK 8	8
DRK 10	10
DRK 12	12
DRK 15	15
DRK 16	16
DRK 18	18

Tech Sheet 20453

Plugs



Male, Metric

0322	Thread
D2612-M12X1.5	M12 x 1.5
D2612-M16X1.5	M16 x 1.5
D2612-M22X1.5	M22 x 1.5

Tech Sheet 20453

Test Point Valve



Male, Metric

0322	Thread	Thread
VPC-M16-M16	M16 x 1.5	M16 x 1.5
VPC-M22-M16	M22 x 1.5	M16 x 1.5

Tech Sheet 20453

Inflation alve



Male x Female, Metric

0322	Thread
V604-M22-S01	M22 x 1.5

Tech Sheet 20453

Drain Valve



Male, Metric

0322	Thread
VDC-M22-S01	M22 x 1.5

Tech Sheet 20453

Push-in Connector



Male Metric Fittings Mod D6512

0322	Thread	OD mm
D6512-4-M10	M10 x 1	4

Tech Sheet 20453



For PPE
see pages 1750-1760