



techhose

QUALITY CONNECTIONS

Hydraulics

Pneumatics
& Vacuum

Industrial

Compressed Air
& Ring Main

Process &
Instrumentation

Pneumatic & Vacuum

Suction Cup Fittings

FITTINGS

VU/VB/VF/VBL/VBU/VBX/VFC Series

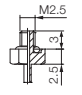
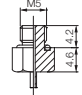
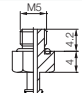
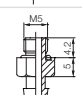
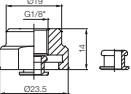
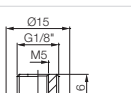
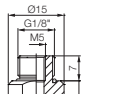
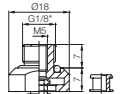
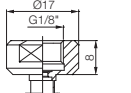
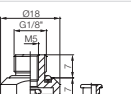
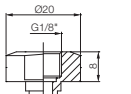
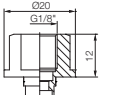
9205	Type	Description	Dimension	Available suction cups	Weight (g)
350 000 3000	M2.5M	Standard		VU2, VU3	0.47
350 000 3100	M5M	Standard		VU2, VU3	0.54
350 000 3101	M5M	Standard		VU4, VU6, VU8, VB5, VB8	1.84
350 000 3102	M5M	Standard		VU10, VU15, VF15, VB10, VB12, VB15, VBL15	2.52
350 010 3102		Built in efficiency valve			2.63
350 000 3321	18FX (For silicone material)	Standard		VU40, VF40	8.46
350 000 3209	M518MF	Standard		VU20, VU25, VU30, VF20, VF25, VF30, VB17, VB20, VBL20	1.82
350 000 5209		Built in mesh-filter			1.92
350 010 4209		Built in efficiency valve			1.94
350 020 4209		Built in button valve			2.21
350 000 1209	M518MFO	Standard		VU20, VU25, VU30, VF20, VF25, VF30, VB17, VB20, VBL20	2.88
350 000 1109		Built in mesh-filter			2.94
350 010 1209		Built in efficiency valve			2.87
350 000 3239	M518MFB (For silicone material)	Standard		VB17, VB20, VBL20	3.56
350 000 3310	18F	Standard		VU20, VU25, VU30, VF20, VF25, VF30, VB17, VB20, VBL20	3.23
350 000 4310		Built in mesh-filter			3.3
350 010 3310		Built in efficiency valve			3.43
350 020 3310		Built in button valve			
350 000 3229	M518MFX (For silicone material)	Standard		VU20, VU25, VU30, VF20, VF25, VF30	3.71
350 000 3311	18F	Standard		VU40, VF40, VB30, VB40, VBL30, VBL40, VBU35, VBU45, VBX35, VBX45	5.62
350 000 4311		Built in mesh-filter			5.72
350 010 3311		Built in efficiency valve			5.86
350 020 3311		Built in button valve			8.97
350 000 2311	18FO	Standard		VU40, VF40, VB30, VB40, VBL30, VBL40, VBU35, VBU45, VBX35, VBX45	8.24
350 000 4811		Built in mesh-filter			8.41

VU/VB/VF/VBL/VBU/VBX/VFC Series

9205	Type	Description	Dimension	Available suction cups	Weight (g)
350 000 3331	18FB (For silicone material)	Standard		VB30, VB40, VBL30, VBL40, VBU35, VBU45	9.78
350 000 2304	18M	Standard		VU40, VF40, VB30, VB40, VBL30, VBL40, VBU35, VBU45, VBX35, VBX45	5.68
350 000 4304		Built in mesh-filter			5.73
350 010 2304		Built in efficiency valve			5.63
350 000 3404	14M	Standard		VU40, VF40, VB30, VB40, VBL30, VBL40, VBU35, VBU45, VBX35, VBX45	5.88
350 000 3804		Built in mesh-filter			5.92
350 010 3404		Built in efficiency valve			6.03
350 000 3504	38M	Standard		VBU35, VBU45, VBX35, VBX45	9.16
350 000 3904		Built in mesh-filter			9.56
350 010 3504		Built in efficiency valve			9.72
350 000 3312	18F	Standard		VU50, VF50 VB50, VBL50 VBU55, VBX55	14.47
350 000 4312		Built in mesh-filter			14.58
350 010 3312		Built in efficiency valve			15.81
350 000 1312	18FO	Standard		VU50, VF50, VB50, VBL50, VBU55, VBX55	10.12
350 000 4912		Built in mesh-filter			10.2
350 010 1312		Built in efficiency valve			10.22
350 000 3405	14M	Standard		VU50, VF50, VB50, VBL50, VBU55, VBX55	14.18
350 000 3805		Built in mesh-filter			14.42
350 010 3405		Built in efficiency valve			14.38
350 000 3505	38M	Standard		VU50, VF50, VB50, VBL50, VBU55, VBX55	18.14
350 000 3905		Built in mesh-filter			17.75
350 010 3505		Built in efficiency valve			17.53
350 000 3342	18FB2 (For silicone material)	Standard		VBU35, VBU45	5.4
350 000 3442		Built in mesh-filter			5.5
350 010 3342		Built in efficiency valve			5.64
350 000 3341	18MB2 (For silicone material)	Standard		VBU35, VBU45	5.44
350 000 4341		Built in mesh-filter			5.33
350 010 3341		Built in efficiency valve			5.47
350 010 3342	18FB2 (For silicone material)	Built in efficiency valve		VBU55, VBX55	15.95
350 000 3441	14MB2 (For silicone material)	Standard		VBU35, VBU45	5.88
350 000 3841		Built in mesh-filter			6
350 010 3441		Built in efficiency valve			6.14

FITTINGS

VU/VB/VF/VBL/VBU/VBX/VFC Series

9205	Type	Description	Dimension	Available suction cups	Weight (g)
350 000 3443	14MB2 (For silicone material)	Standard		VBU55	16.69
350 000 3843		Built in mesh-filter			17.22
350 010 3441		Built in efficiency valve			17.26
350 000 3543	38MB2 (For silicone material)	Standard		VBU55	16.69
350 000 3943		Built in mesh-filter			17.05
350 010 3543		Built in efficiency valve			17.11
350 000 3323	18F	Standard		VB75, VB75B, VF75, VF90, VFC90, VFC100	59.36
350 000 4323		Built in mesh-filter		59.76	
350 020 3323		Built in button valve		VF75, VF90	83.56
350 000 3423	14F	Standard		VB75, VB75B, VF75, VF90, VFC90, VFC100	56.92
350 000 3823		Built in mesh-filter			57.32
350 000 3523	38F	Standard		VB75, VB75B, VF75, VF90, VFC90, VFC100	55.08
350 000 3923		Built in mesh-filter			55.48
350 000 3623	12F	Standard		VB75, VB75B, VF75, VF90, VFC90, VFC100	51.50
350 000 4023		Built in mesh-filter			51.90
350 000 3614	12F	Standard		VB110, VB110B, VF110	103.70
350 000 4014		Built in mesh-filter			10.50
350 020 3614		Built in button valve			VF110
350 000 3615	12F	Standard		VB150, VF150	198.93
350 000 4015		Built in mesh-filter			199.73
350 020 3615		Built in button valve			VF150
350 000 1405	M16M	Standard		VF50X2	52.23
350 000 3616	12F	Standard		VF200	555
350 000 4016		Built in mesh-filter			555.3

BL5040 Series

9205	Type	Description	Dimension	Available suction cups	Weight (g)
350 005 0101	18F	Standard		BL5040	11.24
350 005 0103		Built in mesh-filter			11.27
350 005 0202	14M	Standard		BL5040	7.92
350 005 0204		Built in mesh-filter			8.96
350 005 0302	38M	Standard		BL5040	11.47
350 005 0304		Built in mesh-filter			11.51

VOBL35x90 Series

9205	Type	Description	Dimension	Available suction cups	Weight (g)
350 000 3660	12F	Standard		VOBL35x90	18.7

VOU Series

9205	Type	Description	Dimension	Available suction cups	Weight (g)
350 002 1012	M5M	Standard		VOU4x20, VOU6X20, VOU8X20, VOU8X30, VOU10X30	1.78
350 002 1112	M5F	Standard		VOU4x20, VOU6X20, VOU8X20, VOU8X30, VOU10X30	2.82
350 002 3021	18M	Standard		VOU15x45, VOU20X60	13.74
350 002 3022		Built in mesh-filter			13.84
350 002 3121	18F	Standard		VOU15x45, VOU20X60	10.32
350 002 3122		Built in mesh-filter			10.46

FF Series

9205	Type	Description	Dimension	Available suction cups	Weight (g)
350 007 0101	M5M	Standard		FF15	1.41
350 007 0102	M5M	Standard		FF20, FF25, FF30	2.59
350 007 0103	M5M	Standard		FF15X, FF20X	2.41

SUCTION CUPS - FITTINGS



BL5040 Series

9205
350 005 0101
350 005 0103
350 005 0202
350 005 0204
350 005 0302
350 005 0304

Dimensions

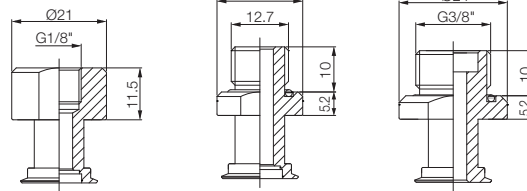

VOBL 35 x 90 Series

9205
350 000 3660

Dimensions

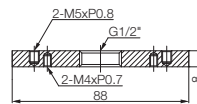

VOU Series

9205
350 002 1012
350 002 1112
350 002 3021
350 002 3022
350 002 3121
350 002 3122

Dimensions

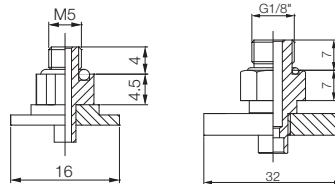

FF Series

9205
350 007 0101
350 007 0102
350 007 0103

Dimensions

